

Dimensions (mm)

MSU-10RD2/SW2/BL2

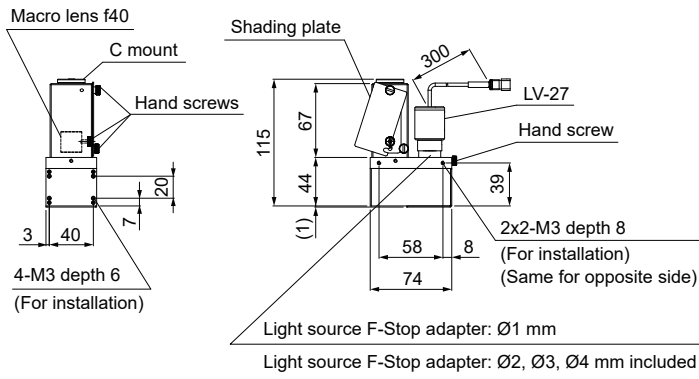

MSU-30RD2/BL2

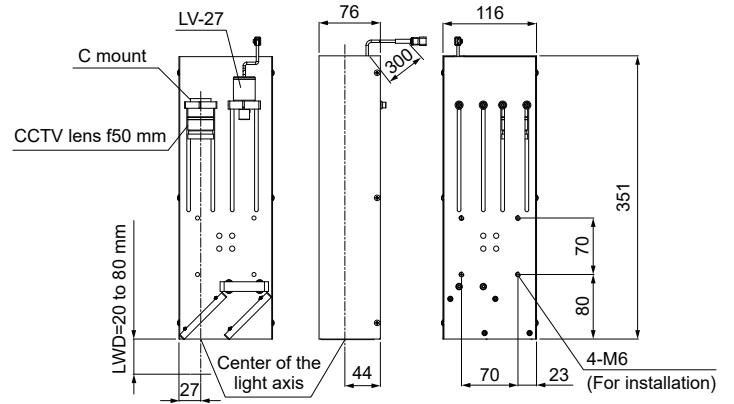

MSU-30X20RD2/SW2/BL2/GR2

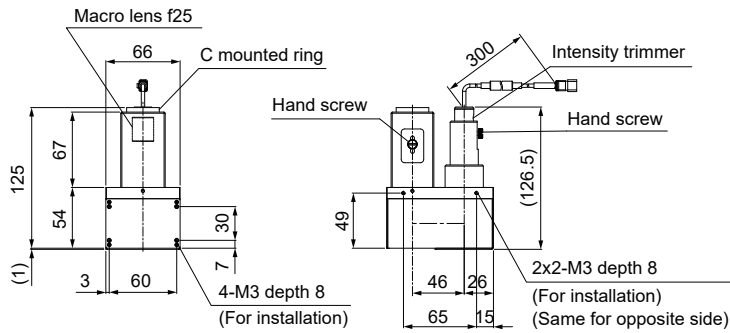

MSU-100RD2/SW2

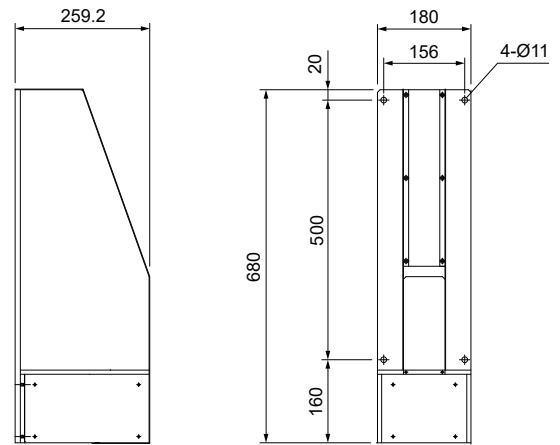

MSU-130RD2/SW2-CL

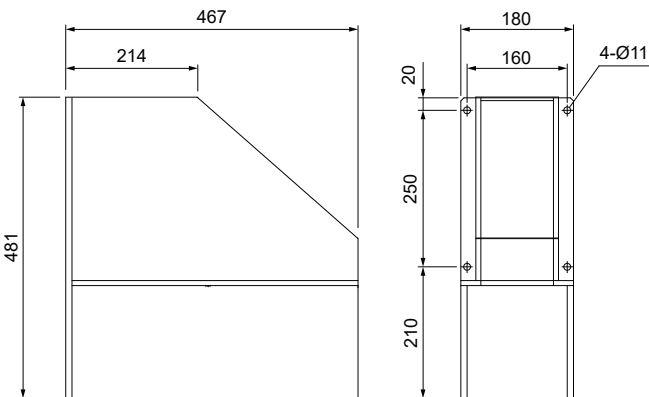

Reference chart for the field of vision (Estimate)
Using a 1/3 inch sensor camera

Model name	Field of vision	WD
MSU-10	7.5 mm	58 mm
MSU-30	18.7 mm	50 mm
MSU-30X20	15 mm	24 mm
MSU-100	60 mm	50 mm

Regarding reference field of vision
This is an estimate to help you select a Light Unit, and individual units may vary from the data listed above depending on your imaging conditions.

You can change the connectors of the Light Unit cable. Choose between M12 connectors and flying leads. Refer to P.7 for details.